

Translation in accordance with the original French version of Quote No. D160922-036

Mme Michelle Smith McGrade  
 4020 Résidence Prince des Cimes  
 Arc 1950 Le Village  
 73700 Bourg Saint Maurice

Site location : 4020 Prince des Cimes, 73700 Arc 1950  
 Nature of works : upstairs renovation – bedroom, bathroom, creation of shower room/toilet, floors, carpentry work, etc.

QUOTE N° D160922-036UK		Date : 16/09/2022				
Quotation received before the start of works, validity period 30 days						
N°	DESCRIPTION - P1/6	VAT	Qty	U	U.P	Total HT
001	SITE SETUP AND REMOVAL	10%	40	Ft	100,00	4 000,00 €
002	1) Packing of cupboard contents					
003	2) Removal and storage of furniture, decorative elements and lighting					
004	3) Total removal with sorting and disposal in the recycling center of the following items:					
005	- carpeted floor stairs, hallway and bedrooms, tiled bathroom floor, sanitary fittings and lighting fixtures					
006	- all items of electrical equipment					
007	- partitions according to plans below					
008	4) Re-installation (or disposal at the customer's request) of furniture, decorative elements and lighting placed in storage					
009	5) End-of-work cleaning and replacement of the contents of the storage cupboards					
Sub-Total HT site setup and removal		N°1				4 000,00 €
FLOORS - Materials included						
010	FLOORING - entire 1st floor	10%	1	Ft	7890,00	7 890,00 €
011	Preparation of the screed : glue removal, hole and crack filling, application of primer and leveling compound					
012	Installation of COREtec® XL-END extra long boards specified planks 2100 x 228 mm - natural wood flooring look, "Montclair" colour					
013	OLD WOOD INTERIOR JOINERY "Sun-burned range"	10%	1	Ft	1390,00	1 390,00 €
014	Fabrication and installation of skirting boards					
Sub-Total HT floors		N°2				9 280,00 €

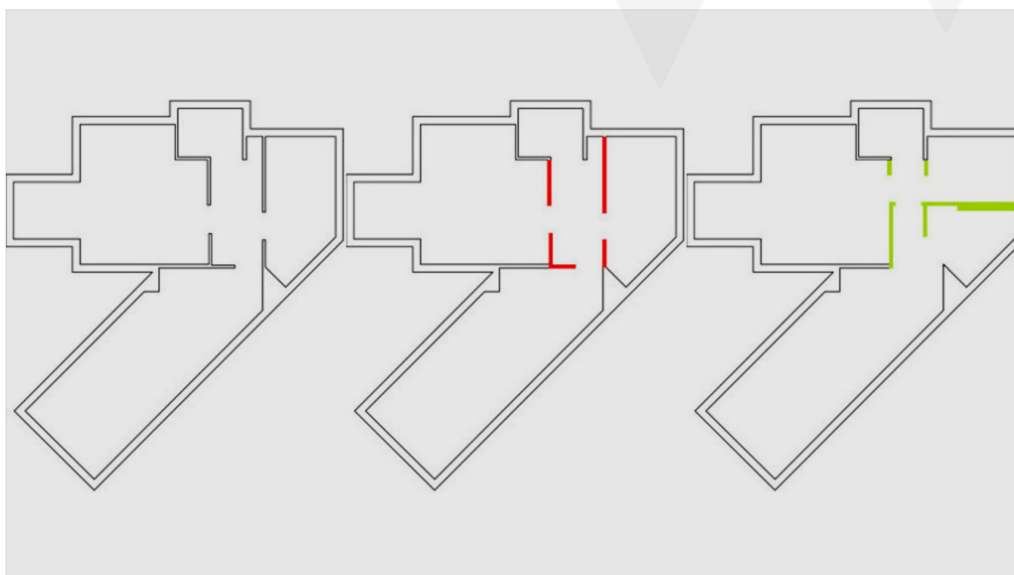

N°	DESCRIPTION - Quote N° D160922-036UK - P2/6	VAT	Qty	U	U.P	Total HT
<b>PARTITIONS, CEILINGS, PLUMBING, ELECTRICITY - Materials included</b>						
015	PARTITIONS - hallway, bedrooms, bathroom area and creation of a shower room	10%	1	Ft	6900,00	6 900,00 €
016	Removal of existing partitions and disposal to the recycling center					
017	Construction of metal frame partitions with rock wool insulation and water-repellent plasterboard, according to visual in P1					
018	Tape plasterboard joins, plaster fill and sand smooth					
019	PLUMBING WORK - bathroom and shower room area					
020	Installation of water inlets and waste water evacuations – mixer taps, suspended basins, bath taps, shower taps	10%	1	Ft	3480,00	3 480,00 €
021	Installation of support frame for wall-hung toilet with built-in cistern GEBERIT Duofix "Sigma"	10%	2	Ft	715,00	1 430,00 €
022	ELECTRICAL WORKS - hallway, bedrooms, bathroom area and new shower room	10%	1	Ft	2300,00	2 300,00 €
023	Installation of conduit for the distribution of the required electrical circuits					
024	Installation of power supplies : sockets, switches, heated towel rails, smart cabinets					
025	PAINT - hallway, bathroom and shower room off tiled walls					
026	Filling of cracks and holes, 2 coats of paint to walls - equivalent colour Farrow&Ball "Cornforth White N°228" matt finish	10%	1	Ft	1150,00	1 150,00 €
027	OLD WOOD INTERIOR JOINERY "Sun burned range"					
028	Ceilings - hallway, stairwell, bathroom and shower room					
029	Installation of conduit for the distribution of the required electrical circuits and recessed spotlights	10%	1	Ft	550,00	550,00 €
030	Creation of a false ceiling with old wood cladding boards and cut-outs for recessing spotlights	10%	1	Ft	2500,00	2 500,00 €
031	Bath panel - bathroom					
032	Fabrication of a bath panel in old wood 3-ply 1-side, and application of a water-repellent finish	10%	1	Ft	490,00	490,00 €
033	Interiors doors - bedrooms, bathroom and shower room					
034	Installation of 4 old wood doors and frames with locks and handles included	10%	4	Ft	1250,00	5 000,00 €
035	ELECTRICAL EQUIPMENT AND LIGHTING ELEMENTS - hallway, bathroom and shower room	10%	1	Ft	1500,00	1 500,00 €
036	Electrical equipment : installation of 1x two-way single switch + 2x double, 3x single power sockets and 2x radiator cable outlets					
037	Lighting : recessed ceiling spotlights					
Sub-Total HT partitions, ceilings, plumbing, electricity						N°3 25 300,00 €
<b>BEDROOM - Materials included ( unless otherwise specified*** )</b>						
038	PAINT	10%	1	Ft	1300,00	1 300,00 €
039	Filling of cracks and holes, 2 coats of paint to walls - equivalent colour Farrow&Ball "Cornforth White N°228" matt finish					
040	OLD WOOD INTERIOR JOINERY "Sun burned range"					
041	Headboard wall cladding : horizontal installation of old wood cladding with false vertical beams, and integration of 2 bedside shelves	10%	1	Ft	1755,00	1 755,00 €
042	Mirror : fabrication and installation of a wall element in old wood, width 40cm x height 140cm	10%	1	Ft	535,00	535,00 €
043	Clothes rack : fabrication and installation of a vertical wall element with hooks and steel bar, in old wood, width 40cm x height 140cm	10%	1	Ft	535,00	535,00 €
044	ELECTRICAL EQUIPMENT AND LIGHTING ELEMENTS	10%	1	Ft	570,00	570,00 €
045	Electrical equipment : installation of 1x two-way single switch + 2x double, 2 single power sockets + 1x double, and 1 radiator cable outlets					
046	Headboard lighting : installation on the old wood cladding of 2x lighting***					
047	Wall lighting facing the bed : installation of a wall light***					
Sub-Total HT bedroom						N°4 4 695,00 €
<b>BATHROOM - Materials included</b>						
048	WALL COVERING	10%	1	Ft	3625,00	3 625,00 €
049	Installation of glazed stoneware wall tiles, glossy finish, XL size 45X120CM - PORCELANOSA "Durango Acero Brillo" gray beige colour					
050	BATHROOM EQUIPMENT - Included : delivery, installation, connection and finishing	10%	1	Ft	11760,00	11 760,00 €
051	Countertop washbasin in fine Ceramic stoneware (céramic) GEBERIT Xeno², colour "White KeraTec", shelf on the right, 90x48cm					
052	Rectangular recessed bathtub in sanitary acrylic GEBERIT Renova Plan, colour "White, 170x75cm					
053	Pivoting bath screen closing aluminium profile, 6mm tempered safety glass, transparent finish, opening width 85cm					
054	Wall-hung toilet set, washdown, shrouded RIMFREE Acanto, with slim WC seat with automatic lowering and quick-release, colour "White KeraTech"					
055	Flush plate for dual flush GEBERIT Sigma 01, colour "Gloss Chrome-plated"					
056	Single lever basin mixer HANS GROHE Axor Vernis Blend, height 100mm, finish "Glossy Chrome"					
057	Showerpipe 200 1 jet EcoSmart with bath thermostat HANS GROHE Axor Vernis Blend, finish "Glossy Chrome"					
058	Wall unit GEBERIT Xeno², glossy / white, with 2 drawer, push-to-open opening mechanism and LED light, 88x53x46,2cm					
059	Smart Cabinet GEBERIT Option, with integrated indirect lighting and two doors, USB port, Power socket, magnetic holder, etc. 75x70cm					



N°	DESCRIPTION - Quote N° D160922-036UK - P3/6	VAT	Qty	U	U.P	Total HT
----	---	-----	-----	---	-----	----------

- 060 Bathroom radiator towel warming, connectivity and remote control via application THERMOR Riviera 2 - 750W, colour " White satin", 55x140cm  
061 Towel ring HANSGROHE AddStoris, finish "Glossy Chrome"  
062 Towel hook double HANSGROHE AddStoris, finish "Glossy Chrome"  
063 Roll holder without cover HANSGROHE AddStoris, finish "Glossy Chrome"  
064 Toilet brush holder wall-mounted HANSGROHE AddStoris, finish "Glossy Chrome"  
065 Pedal bin HANSGROHE AddStoris, finish "Glossy Chrome"

Sub-Total HT bathroom N°5

15 385,00 €

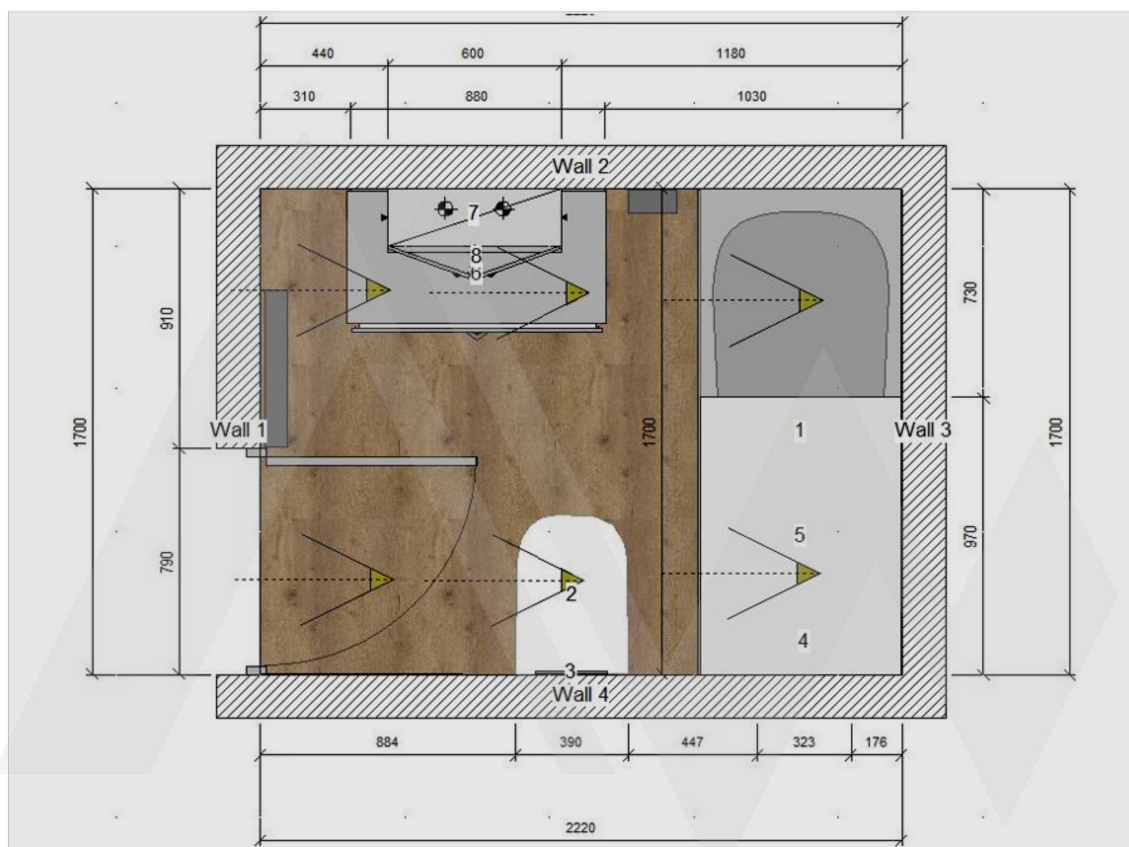

BEDROOM WITH EN-SUITE - Materials included ( unless otherwise specified\*\* )

066 FALSE CEILING CREATION	10%	1	Ft	3150,00	3 150,00 €
067 Concealment of the existing wooden ceiling (not including beams) : installation of a false ceiling in plasterboard					
068 PAINT	10%	1	Ft	1600,00	1 600,00 €
069 Filling of cracks and holes, 2 coats of paint to walls and new ceiling - equivalent colour Farrow&Ball "Cornforth White N°228" matt finish					
070 OLD WOOD INTERIOR JOINERY "Sun burned range"					
071 Headboard wall cladding : horizontal installation of old wood cladding with false vertical beams, and integration of 2 bedside shelves	10%	1	Ft	1885,00	1 885,00 €
072 Mirror : fabrication and installation of a wall element in old wood, width 40cm x height 140cm	10%	1	Ft	535,00	535,00 €
073 Clothes rack : fabrication and installation of a vertical wall element with hooks and steel bar, in old wood, width 40cm x height 140cm	10%	1	Ft	535,00	535,00 €
074 Owner's cupboard with lock : fabrication and installation of a closet integrated into the frame in old wood of a 3-ply 1-side, with shelves	10%	1	Ft	1850,00	1 850,00 €
075 and structure in pine, width 80cm x depth 60cm					
076 Light cover for LED lighting : fabrication and installation of an element in old wood panel 3-ply 1-side	10%	1	Ft	1120,00	1 120,00 €
077 ELECTRICAL EQUIPMENT AND LIGHTING ELEMENTS	10%	1	Ft	965,00	965,00 €
078 Electrical equipment : installation of 1x two-way single switch + 2x double, 2 single power socket + 1 double, and 1 radiator cable outlets					
079 Headboard lighting : installation on the old wood cladding of 2x lighting***					
080 Wall lighting opposite the bed : installation of an LED strip and a transformer					

Sub-Total HT bedroom with en-suite N°6

11 640,00 €





www.antonwood.fr  
 mail@antonwood.fr  
 06 52 52 42 73

N°	DESCRIPTION - Quote N° D160922-036UK - P4/6	VAT	Qty	U	U.P	Total HT
<b>SHOWER ROOM - Material included</b>						
081	WALL COVERING	10%	1	Ft	3625,00	3 625,00 €
082	Installation of glazed stoneware wall tiles, glossy finish, XL size 45X120CM - PORCELANOSA "Durango Acero Brillo" gray beige colour					
083	SHOWER ROOM EQUIPMENT - Included : delivery, installation, connection and finishing	10%	1	Ft	12350,00	12 350,00 €
084	Countertop washbasin in fine Ceramic stoneware (céramic) GEBERIT Xeno², colour "White KeraTec", 60x48cm					
085	Solid surface shower base – PORCELANOSA Krion® Unique P801, color " Snow White, satin finish" 90x80cm					
086	180° pivoting shower screen, chromed aluminum upright, 6mm tempered securit glass, transparent finish, opening width 80cm					
087	Wall-hung toilet set, washdown, shrouded RIMFREE Acanto, with slim WC seat with automatic lowering and quick-release, colour "White KeraTech"					
088	Flush plate for dual flush GEBERIT Sigma 01, colour "Gloss Chrome-plated"					
089	Single lever basin mixer HANSGRÖHE Axor Vermis Blend, height 100mm, finish "Glossy Chrome"					
090	Showerpipe 200 1 jet EcoSmart with thermostat HANSGRÖHE Axor Vernis Shape, finish "Glossy Chrome"					
091	Wall unit GEBERIT Xeno², glossy / white, with 2 drawer, push-to-open opening mechanism and LED lighth, 58x53x46,2cm					
092	Smart Cabinet GEBERIT Option, with integrated indirect lighting and two doors, USB port, Power socket, magnetic holder,etc. 60X70cm					
093	Bathroom radiator towel warming, connectivity and remote control via application THERMOR Riviera 2 - 750W, colour " White satin", 55x140cm					
094	Towel ring HANSGRÖHE AddStoris, finish "Glossy Chrome"					
095	Towel hook double HANSGRÖHE AddStoris, finish "Glossy Chrome"					
096	Roll holder without cover HANSGRÖHE AddStoris, finish "Glossy Chrome"					
097	Toilet brush holder wall-mounted HANSGRÖHE AddStoris, finish "Glossy Chrome"					
098	Pedal bin HANSGRÖHE AddStoris, finish "Glossy Chrome"					
Sub-Total HT shower room N°7						15 975,00 €

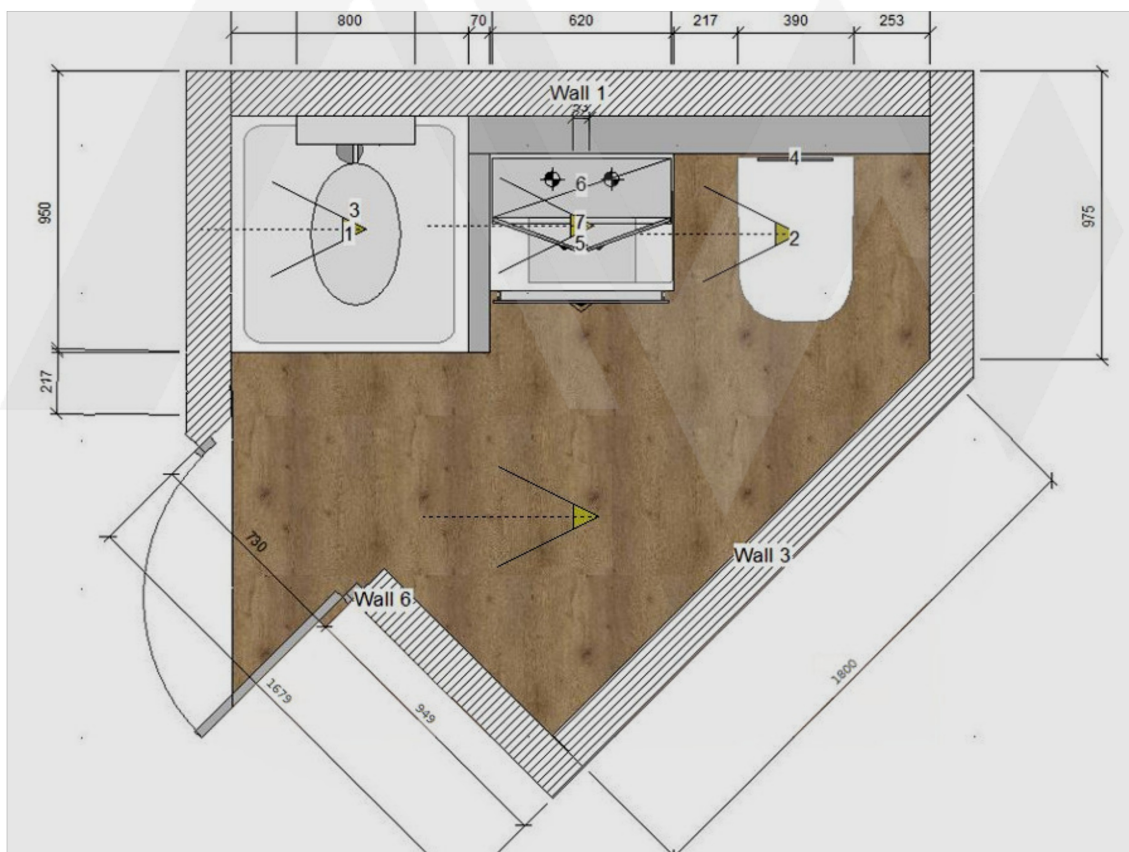





N°	DESCRIPTION - Quote N° D160922-036UK - P5/6	VAT	Qty	U	U.P	Total HT
<b>STAIRCASE AREA - Material included</b>						
099	STEPS STAIRCASE AND STAIRWELL	10%	1	Ft	8980,00	8 980,00 €
100	Fabrication and installation of steps and risers in solid oak wood with application of a protective varnish					
101	Cladding at the height of the baseboard of the 1st floor of the exterior wall with old wood "Sun burned range" cladding boards					
102	Painting of the exterior wall 2 coats with filling of cracks and holes – equivalent Farrow&Ball "Cornforth White N°228" matt finish					
103	Stairwell lighting : installation of an Up and Down wall light***					
Sub-Total HT staircase area N°8						8 980,00 €

104	Notes
105	<b>Choice of materials included in the quote</b> → project web page : <a href="http://antonwood.fr/arc-1950-renovation-project-4020pdc-2023/">http://antonwood.fr/arc-1950-renovation-project-4020pdc-2023/</a>
106	N°34 : interior door handle Hoppe Toulon, colour "Opaque Noir", matt finish
107	N°36,45,78 : Hager Gallery electrical equipment, "Pure" colour on painted walls, and "Nigth" colour on old wood
108	N°37 : recessed ceiling spotlights, "White" colour for bathroom and shower room ceilings, and "Black" colour for hall/corridor ceiling
109	N°46,47,79,103 : the supply of wall lights is not included, the items will be chosen later. Their installation is included in the quote
110	N°10 : ré-installation ( ou la mise en déchetterie sur demande du client ) du mobilier, des éléments de décoration et d'éclairage mis en stockage
111	Prices include supply, delivery and installation of items, unless otherwise stated***
112	The shades of colors and aspects of the natural materials may vary according to the batches (ex: the variation in color of the old sunburnt wood goes from honey to brown through gray)
113	Schedule: The work will take place during the autumn 2023 resort closure period, Sept/Oct/Nov. the work will be completed no later than December 7, 2023

Total amount of the market HT	95 255,00 €
Total VAT amount of the market	9 525,50 €
<b>Total amount TTC</b>	<b>104 780,50 €</b>

TOTAL H.T		95 255,00 €
HT Basis	% VAT	VAT Amount
95 255,00 €	10%	9 525,50 €
0,00 €	20%	0,00 €

<b>Terms of payment</b>		
40%	deposit on signing the quote/slot booking	41 912,20 €
40%	deposit at the start of the quote	41 912,20 €
20%	at the end of works / receipt of balance invoice	20 956,10 €
titulaire : AW SARL - Banque Populaire Courchevel - IBAN : FR76 1680 7000 6936 2600 6221 629 - SWIFT/BIC : CCBPFRPPGR		

" For the company (signature and stamp) "	( For the customer Initial at the bottom of each page, and sign below, preceded by the handwritten mention : ) " Lu et approuvé, bon pour accord "
Date Signature	

N°	DESCRIPTION - Quote N° D160922-036UK - P6/6	VAT	Qty	U	U.P	Total HT
----	---	-----	-----	---	-----	----------

# **GENERAL CONDITIONS OF SALE SARL AW** Relating to quote No. D160922-036UK

- SCOPE.** Acceptance of SARL AW's offer entails the acceptance of these conditions, except for items and services sold and remaining unpaid, expressly to the contrary. If the customer is a professional and is subject to receivership or judicial liquidation, the company reserves the right to claim the goods in the context of legal proceedings.
- VAT.** To benefit from 10% VAT, the customer must send the company an original copy of a certificate on a CERFA N°1310-SD form, provided for the application of the reduced rate. The document must be duly completed, dated and signed. If this condition is not met, the company will not be able to issue an invoice with a reduced rate of VAT, and will be obliged to apply the current rate of 20%.
- VALIDITY OF THE OFFER.** The price indicated on the proposal is valid for a period of 30 days. Beyond that, the company reserves the right either to maintain its offer or to present a new proposal. Payment is made according to the conditions indicated on the proposal or the contract.
- WARRANTY.** The equipment supplied by SARL AW is guaranteed against any construction defect or defect in raw materials for the period indicated on the documents (invoices, estimates, orders, etc.), from the date of delivery or availability. The guarantee is limited to the choice of SARL AW, to the repair or replacement of parts implemented out of service as a result of defects or hidden defects pre-existing on delivery. It does not apply to replacement or repairs resulting from: normal wear and tear of the product; b) damage or accidents resulting from lack of maintenance; c) damage or accidents resulting from incorrect use; d) damage or accidents resulting from the abnormal humidity of the building. To allow himself to remedy the defect found, the Buyer must grant SARL AW the time and facilities required. The company is released from all liability if the Buyer refuses to grant it.
- RESPONSIBILITY.** SARL AW's liability is strictly limited to the obligations defined in these general conditions of sale and the special conditions resulting from a writing signed by SARL AW and the Buyer. It is expressly agreed that SARL AW will not be liable for any compensation towards the buyer for any prejudice such as immaterial damage and which are the direct or indirect consequences of the damage suffered by the items delivered or the work carried out. In the event that the work requires an authorization (such as a building permit, co-ownership authorization, etc.) the Buyer is solely responsible for obtaining it and undertakes to provide SARL AW, prior to the delivery of the products, the necessary supporting documents. Failure to obtain authorization shall in no way engage the responsibility of SARL AW or constitute a reason for termination of the contract.
- INSURANCE.** The company is covered for all its obligations and responsibilities and has all the relevant insurance certificates to this effect. Compulsory ten-year civil liability insurance taken out with MAAF PRO Assurances SA – Chaban, 79180 Chauray, represented by: Agence MAAF 74 Square de la Liberté 73600 MOUTIERS – Tel: 04.79.22.65.55 E-mail: agence.moutiers@maaf.fr. Risk coverage in mainland France and in the overseas departments. Contract number: 173010650 T – MCE – 001
- HEALTH AND SAFETY.** The company undertakes to take all measures and prevent occupational risks in terms of health and safety. It may, at the request of the project manager perform the function of coordinator in accordance with the regulations in force. The project manager must contractually grant the company the means and the necessary authority.
- PERFORMANCE TIME.** As the products are mostly made to measure, their availability cannot be known on the date of signature of the contract: SARL AW does however make every effort to ensure that the installation or delivery takes place on the date agreed between the parties. The work will therefore be carried out without deadline conditions or within a deadline specified in the estimate, or that resulting from a schedule drawn up in agreement with the companies of other trades and the client (or his representative). In the event that the customer uses credit to finance the work, the execution period can only begin to run from the date of obtaining the loan. SARL AW is automatically released from any commitment relating to delivery times: a) in the event that the information to be provided by the Buyer is not given in due time; b) in the event that access to the installation had not been possible on the scheduled dates due to the Purchaser; c) in the event that the terms of payment have not been complied with by the Buyer; d) in the event of force majeure, government restrictions or bad weather.
- ACCEPTANCE OF WORKS AND COMPLAINTS.** The customer has the obligation to check the conformity of his order, as well as the quality of installation. Upon completion of its work, the company will offer its client or its representative to sign a report of receipt of work with or without reservations. After acceptance of completed works, the customer is required to pay the final invoice within 48 hours. In the absence of a complaint from the customer within this period, the invoice will be payable. The fact of having paid the invoice will trigger the start of the guarantee. In the absence of an amicable or acceptance, acceptance may be considered to have taken place tacitly if the following two conditions are met: on the one hand, the taking possession of the work as a whole completed by the client having chosen this form of acceptance of work as well as its methods of application, and on the other hand the payment of the work (with a tolerance of 5% of retention of guarantee), as well as the deadlines of the guarantee of perfect completion, the guarantee of good operation, and the ten-year guarantee will begin to run.
- ADDITIONAL WORK.** This estimate covers only the work expressly mentioned therein. Any work that is not provided for or could not be provided for therein, for any reason whatsoever, such as unforeseen difficulties following the removal of the elements necessary for the execution of the work, is outside the scope of this estimate and may be charged extra. Work not provided for in the initial estimate will be the subject of separate amendments to the estimate or purchase order indicating at least the basis for the price estimate, the conditions and, where applicable, the duration of the extension of the execution period..
- PAYMENT TERMS.** Payments will be made without discount for cash payment. A deposit of 40% of all the work will be requested when ordering/signing the estimate. A deposit of 40% will be requested at the start of the implementation on the construction site. The company grants itself the right to establish situation invoices according to the progress of the work and amendments to the estimate. The company also reserves the right not to start work until payment of the installments. The Buyer can never, under the pretext of a complaint made by him against SARL AW, retain any right not to start the work until the payment of the deposit. The Buyer may never, under the pretext of a complaint made by him against SARL AW, withhold all or part of the sums due by him or demand compensation.
- LATE PAYMENT.** In the event of late payment and payment of sums owed by the Buyer beyond the fixed deadline, and after the date of payment appearing on the invoice sent to the latter, a late payment penalty calculated at the interest rate applied by the ECB to its most recent refinancing operation increased by 10 points of the amount including tax of the acquisition price appearing on the invoice will be automatically and automatically acquired by SARL AW without any formality or prior formal notice, without prejudice to any other action that the company would be entitled to bring, in this respect, against the Buyer. Furthermore, in accordance with articles 441-6c. com. and D. 441-5 c. com, a lump sum compensation for recovery costs, in the amount of FORTY (40) Euros will be due, automatically and without prior notification, in the event of late payment. SARL AW reserves the right to ask the Buyer for additional compensation if the recovery costs actually incurred exceed this amount, upon presentation of supporting documents.
- RETENTION OF OWNERSHIP.** Reserve clause: In accordance with the law of May 12, 1980, the goods delivered and the work carried out remain our property until full payment, both of the goods and of the labour. In the event of non-payment, and after formal notice, we reserve the right to recover the goods with dismantling costs and losses borne by the client.
- TECHNICAL REQUIREMENTS.** The work will be carried out in accordance with the rules of the art in force on the date of signature of the estimate; otherwise, a reciprocal agreement will be necessary. The company will refuse any execution of work that does not comply with the rules of the art and may possibly refuse to use materials or products supplied by the customer. The conditions for the supply of materials by the client (or his representative) are provided for in the special conditions.
- AGREEMENT OF THE PARTIES.** The signature by the customer and the company of the estimate implies their total agreement on the nature, the circumstance and the price of the work as well as their condition of payment and execution listed above.
- JURISDICTION.** Any dispute relating to the interpretation and execution of these general conditions of sale is subject to French law. In the absence of an amicable resolution, the dispute will be brought before the Court depending geographically on the company, i.e. the Court of Albertville.