



Translation in accordance with the original French version of Quote No. D270523-047V5

Mme Michelle Smith McGrade  
4020 Résidence Prince des Cimes  
Arc 1950 Le Village  
73700 Bourg Saint Maurice

Address of works : 4020 Prince des Cimes, 73700 Arc 1950

Nature of the work : renovation groundfloor – entrance / lounge / living room / kitchen, chambre / bathroom / toilet, floors, joinery, etc.

**DEVIS N° D270523-047V5UK**

27/05/2023

Devis reçu avant le début des travaux, durée de validité 15 jours, "Quotation received before the start of works, validity period 15 days"

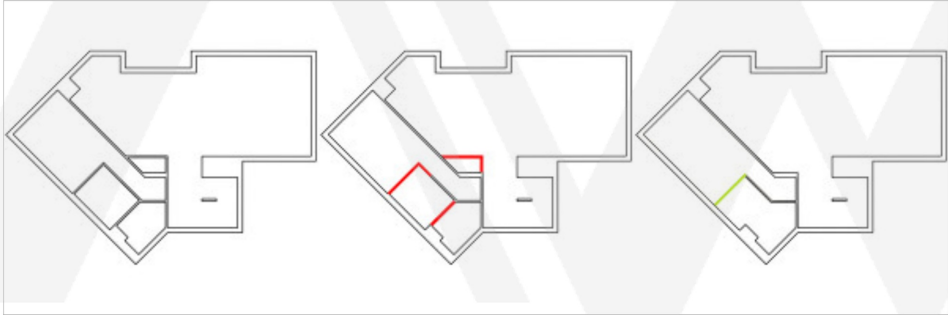
N°	DESCRIPTION - P1/7	VAT	Qty	U	U.P	Total HT
001	SITE SETUP AND REMOVAL	10%	1	Ft	6925,00	6 925,00 €
002	<b>Disposal package – entrance / living room / kitchen / lounge, corridor / bathroom / toilet and bedroom including :</b>					
003	1) Packing of cupboard contents					
004	2) Removal and storage of furniture, decorative elements and lighting					
005	3) Total removal with sorting and disposal to the recycling center of the following items:					
006	- hall cupboard, owner's cupboard and interior doors					
007	- partitions according to detail plan below : hall cupboard / living room cupboard kitchen / toilet - bathroom - bedroom					
008	- tiled floor : entrance, kitchen, in front of the fireplace, bathroom, toilet / carpeted floor : living room, lounge, corridor, bedroom					
009	- kitchen area : furniture, worktop, sink, mixer tap, backsplashes, appliances					
010	- bathroom and toilet area : all sanitary equipment and lighting elements					
011	- all electrical and heating equipment (radiators + towel rails)					
012	4) Re-installation (or disposal at the customer's request) of furniture, decorative elements and lighting placed in storage					
013	5) End-of-work cleaning and replacement of the contents of the storage cupboards					
						
Sub-Total H.T N°1						6 925,00 €

**FLOORS - Materials included**

014	<b>WarmUp floor heating system</b> – Entire ground floor	10%	1	Ft	12000,00	12 000,00 €
015	Preparation of the screed : glue removal, hole and crack filling, application of primer and leveling compound					
016	Gluings of heating mats and installation of electrical cables					
017	Laying a levelling screed in accordance with WarmUp standards for installation with a COREtec® XL-END final floor covering					
018	Wall installation of the connected touchscreens					
019	<b>Flooring</b> – Entire ground floor	10%	1	Ft	13800,00	13 800,00 €
020	Installation of COREtec® XL-END extra long boards specified planks 2100 x 228 mm - natural wood flooring look, "Montclair" colour					
021	<b>Skirting boards</b> – Entire round floor	10%	1	Ft	1980,00	1 980,00 €
022	Fabrication and installation of skirting boards in Old Wood (3 ply/1 side panel)					
Sub-Total H.T N°2						27 780,00 €



N°	DESCRIPTION - Quote N° D270523-047V5UK - P2/7	VAT	Qty	U	U.P	Total HT
<b>ENTRANCE AREA - Materials included</b>						
023	<b>Entrance door :</b>	10%	1	Ft	1170,00	1 170,00 €
024	Installation of an Old Wood cladding					
025	<b>False ceiling :</b>					
026	Installation of conduit for the distribution of the required electrical circuits and recessed spotlights	10%	1	Ft	495,00	495,00 €
027	Creation of a false ceiling with Old Wood cladding, and cut-outs for recessing spotlights	10%	1	Ft	3480,00	3 480,00 €
028	<b>Cupboard integrated into the frame :</b>	10%	1	Ft	4340,00	4 340,00 €
029	Fabrication and installation of 2 melamine pedestals with shelves and hanging tubes (under the stairs)					
030	Fabrication et pose de 2 portes en Vieux Bois (panneau 3 plis/1 face) avec quincaillerie Blum et poignées métal					
031	<b>Fixed wall element :</b>	10%	1	Ft	1529,00	1 529,00 €
033	Fabrication and installation of a vertical wall mounted element in Old Wood with polymer mirror and metal hooks					
034	<b>Painting :</b>	10%	1	Ft	1215,00	1 215,00 €
035	Filling of cracks and holes, 2 coats of paint to walls - equivalent colour Farrow&Ball					
036	<b>Electrical equipment :</b> 1x two-way single switch + 1x double, 1x single power sockets	10%	1	Ft	270,00	270,00 €
037	<b>Lighting :</b> recessed ceiling spots in black colour	10%	1	Ft	570,00	570,00 €
Sub-Total H.T N°3						<b>13 069,00 €</b>

<b>DINING AREA AND LOUNGE - Materials included unless otherwise specified*</b>						
038	<b>Living room wall :</b>	10%	1	Ft	0,00	0,00 €
039	Rework of the concrete wall of the living room 1) following the removal of the cladding, 2) and the removal of the owner's cupboard					
040	<b>Extension of the living room wall on the insert side:</b>	10%	1	Ft	0,00	0,00 €
041	Construction of a partition with integrated niches facing the entrance hall					
042	<b>Cornice around the edge of the room:</b>	10%	1	Ft	5710,00	5 710,00 €
043	Fabrication and installation of a cornice in Old Wood (3 ply/1 side panel) with integration of aluminium profiles for LED lighting					
044	<b>Painting :</b>	10%	1	Ft	4080,00	4 080,00 €
045	Filling of cracks and holes, 2 coats of paint to walls and ceiling - equivalent colour Farrow&Ball					
046	<b>Electrical equipment :</b> 2x two-way single switch + 3x double, 6x single power sockets, 1x Tv socket, 1x Tel socket, 2x wall-cover	10%	1	Ft	1360,00	1 360,00 €
047	<b>LED cornice lighting :</b> installation of single colour LED strips and transformers	10%	1	Ft	2650,00	2 650,00 €
048	<b>Dining table lighting *</b> : installation of a suspension (with decentralising kit if necessary)	10%	1	Ft	190,00	190,00 €
Sub-Total H.T N°4						<b>13 990,00 €</b>

<b>FIREPLACE AREA - Materials included</b>						
049	<b>Fabrication of a long bench with backlighting integrated into the frame</b>	10%	1	Ft	8385,00	8 385,00 €
050	Bench on 5 legs with 3 backlit niches in the lower part + 1 log storage niche					
051	- rectangular supports in Old Wood (3 ply/1 side panel) "Burnt sun range"					
052	- elements in old wood (3-ply/1-side panel)					
053	- installation of aluminium profiles and a single-colour LED strip and transformer					
054	- cladding of the lower wall of the bench in natural stone coating "Airlate Kashmir" the Anticcolonial Porcelanosa					
055	<b>Cladding insert</b>					
056	Cladding around the insert (choice of cladding in standby)					
Sub-Total H.T N°5						<b>8 385,00 €</b>



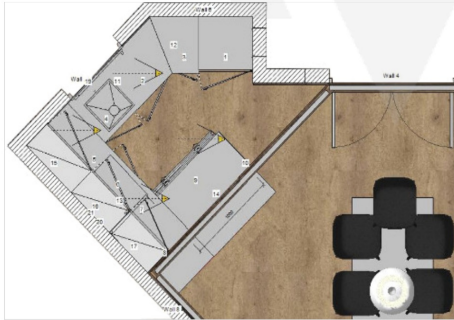

N°	DESCRIPTION - Quote N° D27523-047V5 - P3/7	VAT	Qty	U	U.P	Total HT
<b>KITCHEN - Materials included</b>						
057	<b>False ceiling</b>					
058	Installation of conduit for the distribution of the required electrical circuits and recessed spotlights	10%	1	Ft	410,00	410,00 €
059	Creation of a suspended false ceiling in water resistant plasterboard	10%	1	Ft	2310,00	2 310,00 €
060	L shaped layout with peninsula	10%	1	Ft	30900,00	30 900,00 €
061	<b>Custom fabrication and installation of the following elements :</b>					
062	Set of units and shelves in melamine					
063	Doors and drawer fronts, and finishing panels - uni decor glass effect, soft touch, with edging in the same colour :					
064	- 7 door fronts, 6 drawers fronts and finishing panels, 4 fillers, 2 end panels					
065	- 1 finishing panels fronts, 4 fillers, 2 end panels					
066	Hardware and fittings :					
067	- Blum Clip Top Blumotion door hinges and Blum Push to Open locking system					
068	Blum Legrabox Pure drawers with Blum Blumotion locking system :					
069	- 2 drawers + 1 pan for the peninsula, 1 drawer under the oven, 2 high Twin Space drawers on each side of the oven					
070	- 6 anti-slip mats for Blum Legrabox Pure drawers - Colour anthracite Grey					
071	- 3 cutlery drawer frames 100mm version Blum AmbiaLine Legrabox					
072	Plinths for under the bottom units, including 2 ventilation grilles					
073	Pull-out waste sorting bin with sliding lid and charcoal filter - capacity 2 x 18L or equivalent					
074	3 Blum Servo-drive motorised openings : 2 for Twin Space drawers and 1 for the refrigerator					
075	<b>Custom fabrication worktops and backsplashes in solid surface Krypton® Porcelanosa</b>					
076	Worktop fabrication with machining and finishing of sink, tap and hob positions					
077	Fabrication of reinforcement frames (in solid surface), installation and finishing					
078	Machining of a drainer grooves in the worktop					
079	Fabrication of an waterfall end for the peninsula					
080	Fitting and jointing of the worktop, sanding and finishing to satin					
081	Installation of an undermount stainless sink "Bradano Allaro 40 x 40cm" a single-lever mixer tap "Bradano Fino 316"					
082	Backsplashes fabrication with machining and finishing of electrical equipments					
083	Fitting and jointing of the worktop, sanding and finishing to satin					
084	<b>Peninsula back cladding</b>	10%	1	Ft	1985,00	1 985,00 €
085	Peninsula back cladding with concealed cupboard					
086	<b>Painting :</b>	10%	1	Ft	1225,00	1 225,00 €
087	Filling of cracks and holes, 2 coats of paint to walls and ceiling - equivalent colour Farrow&Ball					
088	<b>Electrical equipment :</b> 2x two-way double switch, 2x double power sockets, 1x Vmc socket	10%	1	Ft	630,00	630,00 €
089	<b>LED lighting :</b> recessed profiles and single colour LED strip under wall units with transformer	10%	1	Ft	1120,00	1 120,00 €
090	<b>Lighting :</b> recessed ceiling spots	10%	1	Ft	320,00	320,00 €
						
Sub-Total H.T N°6						<b>38 900,00 €</b>
091	<b>Appliances - Supply / Delivery / Installation</b> (Siemens commercial discount-10 % included)					
092	<b>Siemens Iq500 - SX85EX56CE</b> Fully integrated dishwasher XXL 14C, OpenAssist, Drawer Vario, Width.60cm, 42dB	20%	1	Ft	937,49	937,49 €
093	<b>Siemens Iq700 - EX651LYC1F</b> Frameless induction hob, Width.60 cm, Col. Black	20%	1	Ft	862,50	862,50 €
094	<b>Elica Lane - PRF0165834</b> Integrated extractor 72cm, Sound level min-max 49-65 db, Col. Black	20%	1	Ft	499,99	499,99 €
095	<b>Siemens Iq700 - HM676GoS1</b> Integrated oven with microwave function, Pyrolytic + Hydrolytic, 67L, energy class A, 60 x 60cm	20%	1	Ft	1408,44	1 408,44 €
096	<b>Siemens Iq500 - KI82LADFo</b> Integrated fridge with freezer compartment, (252L+34L) Haut.177.5cm - 36db	20%	1	Ft	944,99	944,99 €
Sub-Total H.T N°7						<b>4 653,42 €</b>





N°	DESCRIPTION - Quote N° D270523-047V5UK - P4/7	TVA	Qté	U	P.U	Total HT
CORRIDOR AND BATHROOM - Materials included						
097	<b>Partitions</b>	10%	1	Ft	4395,00	4 395,00 €
098	Construction of metal frame partitions with rock wool insulation and water-repellent plasterboard, according to visual in P1					
099	Tape plasterboard joins, plaster fill and sand smooth					
100	<b>Plumbing works</b>	10%	1	Ft	3925,00	3 925,00 €
101	Installation of water inlets and waste water evacuations – mixer tap, suspended toilet basin, bath taps					
102	Installation of support frame for wall-hung toilet with built-in cistern GEBERIT Duofix "Sigma"					
103	<b>Electrical works</b>	10%	1	Ft	1630,00	1 630,00 €
104	Installation of conduit for the distribution of the required electrical circuits					
105	Installation of power supplies : sockets, switches, heated towel rails, smart cabinets, lighting					
106	<b>False ceiling</b> - Corridor	10%	1	Ft	3890,00	3 890,00 €
107	Installation of conduit for the distribution of the required electrical circuits and recessed spotlights					
108	Creation of a false ceiling with Old Wood cladding, and cut-outs for recessing spotlights					
109	<b>Electric meter cupboard</b> - Corridor :	10%	1	Ft	825,00	825,00 €
110	Fabrication and installation of a pine frame of the same dimensions as the existing one with application of a tint					
111	Fabrication and installation of an Old Wood door (3 ply/1 side panel) with Blum hardware and metal handles					
112	<b>Half-height wall cladding</b> - Bathroom :	10%	1	Ft	765,00	765,00 €
113	Horizontal installation of Old Wood cladding - in the upper part of the formwork of the built-in cistern					
114	<b>Bath panel</b> - Bathroom :	10%	1	Ft	780,00	780,00 €
115	Fabrication of a bath panel in Old Wood (3-ply 1 side panel), and application of a water-repellent finish					
116	<b>Technical column access wall unit</b> - Salle de bain :	10%	1	Ft	1230,00	1 230,00 €
117	Fabrication and installation of a polymer mirror with an Old Wood frame					
118	<b>Wall unit</b> - Bathroom :	10%	1	Ft	990,00	990,00 €
119	Fabrication and installation of a vertical wall unit in Old Wood with metal hooks					
120	<b>Interiors doors</b> : installation of 3 old wood doors and frames with locks and handles	10%	3	Ft	1795,00	5 385,00 €
121	<b>Paint</b> : filling of cracks and holes, 2 coats of paint to walls - equivalent colour Farrow&Ball	10%	1	Ft	1875,00	1 875,00 €
122	<b>Electrical equipment</b> : interrupteur va&vient simple x4 et double x2, prise simple x2, cache radiateur x1	10%	1	Ft	810,00	810,00 €
123	<b>Lighting</b> : encastrément de spots de plafond	10%	1	Ft	665,00	665,00 €
Sub-Total H.T N°8						27 165,00 €

WALL COVERING AND BATHROOM EQUIPMENT - Materials included						
124	<b>Wall covering</b>	10%	1	Ft	4790,00	4 790,00 €
125	Installation of wall tiles, glossy finish, XL size 45X120CM - PORCELANOSA "Durango Acero Brillo" gray beige colour					
126	<b>Bathroom equipment</b> - (with delivery, installation and finishing)	10%	1	Ft	14880,00	14 880,00 €
127	Countertop washbasin in fine Ceramic stoneware (céramic) GEBERIT Xeno², colour "White KeraTec", shelf on the right, 90x48cm					
128	Jacob Delafon Neo recessed bathtub "Bain-Douche" rectangular in sanitary acrylic, colour "White" 170x90cm					
129	Jacob Delafon Neo bath screen, 2 panels, clear glass, profile and chrome hinges					
130	Wall-hung toilet set, washdown, shrouded RIMFREE Acanto, slim WC seat with automatic lowering, colour "White KeraTech"					
131	Flush plate for dual flush GEBERIT Sigma 01, colour "Gloss Chrome-plated"					
132	Single lever basin mixer HANS GROHE Axor Vernis Blend, height 100mm, finish "Glossy Chrome"					
133	Showerpipe 200 1 jet EcoSmart with bath thermostat HANS GROHE Axor Vernis Blend, finish "Glossy Chrome"					
134	Wall unit GEBERIT Xeno², glossy / white, 2 drawers, 2 doors push-to-open opening mechanism, etc. 88x53x46cm					
135	Smart Cabinet GEBERIT Option, integrated lighting, USB port, power socket, magnetic holder, etc. 75x70cm					
136	750W programmable towel radiator, connected via THERMOR Riviera 2 application, Satin White color 55x140cm					
137	Towel ring HANS GROHE AddStoris, finish "Glossy Chrome"					
138	Towel rail 2 arms HANS GROHE AddStoris, "Chrome Glossy"					
139	Roll holder without cover HANS GROHE AddStoris, finish "Glossy Chrome"					
140	Toilet brush holder wall-mounted HANS GROHE AddStoris, finish "Glossy Chrome"					
141	Pedal bin HANS GROHE AddStoris, finish "Glossy Chrome"					
Sub-Total H.T N°9						19 670,00 €

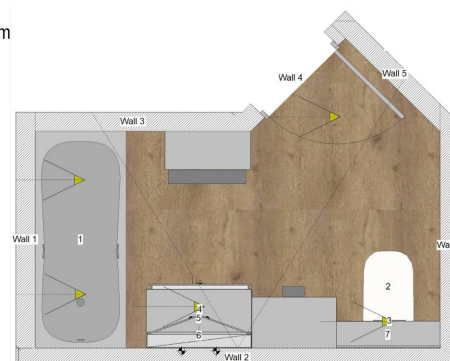





N°	DESCRIPTION - Quote N° D210523-047V4UK - P5/7	VAT	Qty	U	P.U	Total HT
----	---	-----	-----	---	-----	----------

**MASTER BEDROOM** - Materials included unless otherwise specified \*

147	<b>False ceiling</b> - Entrance door space	10%	1	Ft	895,00	895,00 €
148	Installation of conduit for the distribution of the required electrical circuits and recessed spotlights					
149	Creation of a false ceiling with Old Wood cladding, and cut-outs for recessing spotlights					
150	<b>Cornice in perimeter of the room :</b>	10%	1	Ft	2540,00	2 540,00 €
151	Fabrication and installation of a cornice in Old Wood (3 ply/1 side panel) with integration of aluminium profiles for LED lighting					
152	<b>Sleeping area</b> - Frame integrated unit with the following elements :	10%	1	Ft	6115,00	6 115,00 €
153	1 headboard in Old Wood cladding, with cut-outs for electrical equipment					
154	2 bedside units in Old Wood (3 ply/1 side panel) with top in solid surface					
155	<b>Wardrobe area</b> - Frame integrated unit with the following elements :	10%	1	Ft	8315,00	8 315,00 €
156	Wardrobe melamine units with Old Wood doors (3 ply/1 side) with Blum hardware and metal handles					
157	- interior fittings: 6 Blum Legrabox Free drawers, hanging area, storage niches, integrated LED light					
158	<b>Clothes rack</b> : fabrication and installation of vertical elements in Old Wood, with metal bar and hooks on the wall facing the bed	10%	2	Ft	870,00	1 740,00 €
159	<b>Paint</b> : filling of cracks and holes, 2 coats of paint to walls - equivalent colour Farrow&Ball "Cornforth White" N°228	10%	1	Ft	1450,00	1 450,00 €
160	<b>Electrical equipment</b> : 1x two-way single switch + 2x double, 4x single power sockets, 1x Tv socket, 1x Tel socket, 1x wall-cover	10%	1	Ft	515,00	515,00 €
161	<b>Lighting LED cornice</b> : installation of single colour LED strips and transformer	10%	1	Ft	1275,00	1 275,00 €
162	<b>Wall lighting</b> *: installation of 3 wall lights (headboard x2, wall facing bed x1)	10%	1	Ft	180,00	180,00 €

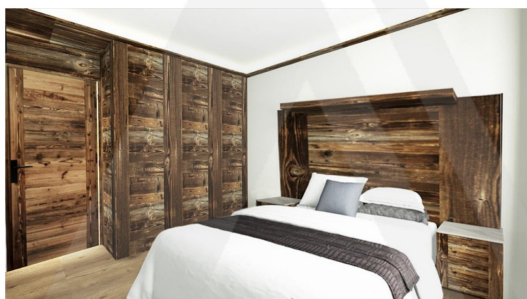

Sub-Total H.T N°10

22 730,00 €

To note that :

Acces to the project page ■ <http://antonwood.fr/arc-1950-prince-des-cimes-summary-projects/>

163	The colour of the COREtec® floor covering is "Montclair"
164	The melamine decor of the entrance cupboard is "Bois de Grange" (this choice can be changed later)
165	The supply of the suspension of the living room is not included, the article will be chosen later. The installation is included in the estimate
166	The colour of the radiator in the Atlantic radiator lounge is "White" (this choice can be changed later)
167	The bench in the fireplace area is made of Old Wood - following the removal of the wooden cladding walls (this can be replaced by steel elements later)
168	The choice of cladding for the insert is to be agreed with the customer at a later date
169	The colour of the melamine for the kitchen cabinets is "U708 Light grey" with edgebanding of the same colour (this choice can be changed later)
170	The colour of the kitchen fronts is "Nebbia Elegant Matt" with edgebanding in the same colour (this choice can be changed later)
171	The colour of the drawers and push to open of the "Blum" kitchen fronts is "Silk White Mat" (this choice can be changed later)
172	The colour of the "Kron® Porcelanosa" worktops and credenzas in the kitchen is "L101 Carrara Dark"
173	The decor of the melamine for the dressing room and the bedside tables units in the bedroom will be agreed with the client at a later date.
174	The colour of the Blum drawers in the bedroom dressing room is to be agreed with the customer at a later date
175	The supply of the 3 wall lights in the room is not included, the items will be chosen later. The installation is included in the estimate
176	The "Blum" hinge colour is "Black Onyx" for all cupboard doors
177	The colour of the "Hager Gallery" electrical equipment is "Pure"
178	The colour of the ceiling spots is "black" for the Vieux Bois ceilings and "white" for the kitchen ceiling
179	The paint colour of the walls and ceilings is "Cornforth White" equivalent Farrow&Ball (this choice can be changed later)



**MASTER BEDROOM** - Materials included unless otherwise specified \*

142	<b>False ceiling</b> - Entrance door space	10%	1	Ft	895,00	895,00 €
143	Installation of conduit for the distribution of the required electrical circuits and recessed spotlights					
144	Creation of a false ceiling with Old Wood cladding, and cut-outs for recessing spotlights					
145	<b>Cornice in perimeter of the room :</b>	10%	1	Ft	2540,00	2 540,00 €
146	Fabrication and installation of a cornice in Old Wood (3 ply/1 side panel) with integration of aluminium profiles for LED lighting					
147	<b>Sleeping area</b> - Frame integrated unit with the following elements :	10%	1	Ft	6115,00	6 115,00 €
148	1 headboard in Old Wood cladding, with cut-outs for electrical equipment					
149	2 bedside units in Old Wood (3 ply/1 side panel) with top in solid surface					
150	<b>Wardrobe area</b> - Frame integrated unit with the following elements :	10%	1	Ft	8315,00	8 315,00 €
151	Wardrobe melamine units with Old Wood doors (3 ply/1 side) with Blum hardware and metal handles					
152	- interior fittings: 6 Blum Legrabox Free drawers, hanging area, storage niches, integrated LED light					
153	<b>Paint</b> : filling of cracks and holes, 2 coats of paint to walls - equivalent colour Farrow&Ball "Cornforth White" N°228	10%	1	Ft	1450,00	1 450,00 €
154	<b>Electrical equipment</b> : 1x two-way single switch + 2x double, 4x single power sockets, 1x Tv socket, 1x Tel socket, 1x wall-cover	10%	1	Ft	515,00	515,00 €
155	<b>Wall lighting</b> : installation of 3 wall lights (headboard x2, wall facing bed x1)	10%	1	Ft	180,00	180,00 €



Sub-Total H.T N°10

20 010,00 €

To note that :

Acces to the project page <http://antonwood.fr/arc-1950-prince-des-cimes-summary-projects/>

156	The colour of the COREtec® floor covering is "Montclair"
157	The melamine decor of the entrance cupboard is "Bois de Grange" (this choice can be changed later)
158	The supply of the suspension of the living room is not included, the article will be chosen later. The installation is included in the estimate
159	The bench in the fireplace area is made of Old Wood - following the removal of the wooden cladding walls (this can be replaced by steel elements later)
160	The choice of cladding for the insert is to be agreed with the customer at a later date
161	The colour of the melamine for the kitchen cabinets is "U708 Light grey" with edgebanding of the same colour (this choice can be changed later)
162	The colour of the kitchen fronts is "Nebbia Elegant Matt" with edgebanding in the same colour (this choice can be changed later)
163	The colour of the drawers and push to open of the "Blum" kitchen fronts is "Silk White Mat" (this choice can be changed later)
164	The colour of the "Krion® Porcelanosa" worktops and credenzas in the kitchen is "L101 Carrara Dark"
165	The decor of the melamine for the dressing room and the bedside tables units in the bedroom will be agreed with the client at a later date.
166	The colour of the Blum drawers in the bedroom dressing room is to be agreed with the customer at a later date
167	The supply of the 3 wall lights in the room is not included, the items will be chosen later. The installation is included in the estimate
168	The "Blum" hinge colour is "Black Onyx" for all cupboard doors
169	The colour of the "Hager Gallery" electrical equipment is "Pure"
170	The colour of the ceiling spots is "black" for the Vieux Bois ceilings and "white" for the kitchen ceiling
178	The paint colour of the walls and ceilings is "Cornforth White" equivalent Farrow&Ball (this choice can be changed later)





mail@antonwood.fr  
06 52 52 42 73

DESCRIPTION - Quote N° D270523-047V5UK - P7/7

Translation P7/7 in accordance with the original French version of Quote No. D270523-047V5

## GENERAL CONDITIONS OF SALE SARL AW Relating to quote No. D250523-047V5UK

- 1) **SCOPE.** Acceptance of SARL AW's offer entails the acceptance of these conditions, except for items and services sold and remaining unpaid, expressly to the contrary. If the customer is a professional and is subject to receivership or judicial liquidation, the company reserves the right to claim the goods in the context of legal proceedings.
- 2) **VAT.** To benefit from 10% VAT, the customer must send the company an original copy of a certificate on a CERFA N°1310-SD form, provided for the application of the reduced rate. The document must be duly completed, dated and signed. If this condition is not met, the company will not be able to issue an invoice with a reduced rate of VAT, and will be obliged to apply the current rate of 20%.
- 3) **VALIDITY OF THE OFFER.** The price indicated on the proposal is valid for a period of 15 days. Beyond that, the company reserves the right either to maintain its offer or to present a new proposal. Payment is made according to the conditions indicated on the proposal or the contract.
- 4) **WARRANTY.** The equipment supplied by SARL AW is guaranteed against any construction defect or defect in raw materials for the period indicated on the documents (invoices, estimates, orders, etc.), from the date of delivery or availability. The guarantee is limited to the choice of SARL AW, to the repair or replacement of parts implemented out of service as a result of defects or hidden defects pre-existing on delivery. It does not apply to replacement or repairs resulting from: normal wear and tear of the product; b) damage or accidents resulting from lack of maintenance; c) damage or accidents resulting from incorrect use; d) damage or accidents resulting from the abnormal humidity of the building. To allow himself to remedy the defect found, the Buyer must grant SARL AW the time and facilities required. The company is released from all liability if the Buyer refuses to grant it.
- 5) **RESPONSIBILITY.** SARL AW's liability is strictly limited to the obligations defined in these general conditions of sale and the special conditions resulting from a writing signed by SARL AW and the Buyer. It is expressly agreed that SARL AW will not be liable for any compensation towards the buyer for any prejudice such as immaterial damage and which are the direct or indirect consequences of the damage suffered by the items delivered or the work carried out. In the event that the work requires an authorization (such as a building permit, co-ownership authorization, etc.) the Buyer is solely responsible for obtaining it and undertakes to provide SARL AW, prior to the delivery of the products, the necessary supporting documents. Failure to obtain authorization shall in no way engage the responsibility of SARL AW or constitute a reason for termination of the contract.
- 6) **INSURANCE.** The company is covered for all its obligations and responsibilities and has all the relevant insurance certificates to this effect. Compulsory ten-year civil liability insurance taken out with MAAF PRO Assurances SA – Chaban, 79180 Chauray, represented by: Agence MAAF 74 Square de la Liberté 73600 MOUTIERS – Tel: 04.79.22.65.55 E-mail: agence.moutiers@maaf.fr. Risk coverage in mainland France and in the overseas departments. Contract number: 173010650 T – MCE – 001
- 7) **HEALTH AND SAFETY.** The company undertakes to take all measures and prevent occupational risks in terms of health and safety. It may, at the request of the project manager perform the function of coordinator in accordance with the regulations in force. The project manager must contractually grant the company the means and the necessary authority.
- 8) **PERFORMANCE TIME.** As the products are mostly made to measure, their availability cannot be known on the date of signature of the contract: SARL AW does however make every effort to ensure that the installation or delivery takes place on the date agreed between the parties. The work will therefore be carried out without deadline conditions or within a deadline specified in the estimate, or that resulting from a schedule drawn up in agreement with the companies of other trades and the client (or his representative). In the event that the customer uses credit to finance the work, the execution period can only begin to run from the date of obtaining the loan. SARL AW is automatically released from any commitment relating to delivery times: a) in the event that the information to be provided by the Buyer is not given in due time; b) in the event that access to the installation had not been possible on the scheduled dates due to the Purchaser; c) in the event that the terms of payment have not been complied with by the Buyer; d) in the event of force majeure, government restrictions or bad weather.
- 9) **ACCEPTANCE OF WORKS AND COMPLAINTS.** The customer has the obligation to check the conformity of his order, as well as the quality of installation. Upon completion of its work, the company will offer its client or its representative to sign a report of receipt of work with or without reservations. After acceptance of completed works, the customer is required to pay the final invoice within 48 hours. In the absence of a complaint from the customer within this period, the invoice will be payable. The fact of having paid the invoice will trigger the start of the guarantee. In the absence of an amicable or acceptance, acceptance may be considered to have taken place tacitly if the following two conditions are met: on the one hand, the taking possession of the work as a whole completed by the client having chosen this form of acceptance of work as well as its methods of application, and on the other hand the payment of the work (with a tolerance of 5% of retention of guarantee), as well as the deadlines of the guarantee of perfect completion, the guarantee of good operation, and the ten-year guarantee will begin to run.
- 9) **ACCEPTANCE OF WORKS AND COMPLAINTS.** The customer has the obligation to check the conformity of his order, as well as the quality of installation. Upon completion of its work, the company will offer its client or its representative to sign a report of receipt of work with or without reservations. After acceptance of completed works, the customer is required to pay the final invoice within 48 hours. In the absence of a complaint from the customer within this period, the invoice will be payable. The fact of having paid the invoice will trigger the start of the guarantee. In the absence of an amicable or acceptance, acceptance may be considered to have taken place tacitly if the following two conditions are met: on the one hand, the taking possession of the work as a whole completed by the client having chosen this form of acceptance of work as well as its methods of application, and on the other hand the payment of the work (with a tolerance of 5% of retention of guarantee), as well as the deadlines of the guarantee of perfect completion, the guarantee of good operation, and the ten-year guarantee will begin to run.
- 10) **ADDITIONAL WORK.** This estimate covers only the work expressly mentioned therein. Any work that is not provided for or could not be provided for therein, for any reason whatsoever, such as unforeseen difficulties following the removal of the elements necessary for the execution of the work, is outside the scope of this estimate and may be charged extra. Work not provided for in the initial estimate will be the subject of separate amendments to the estimate or purchase order indicating at least the basis for the price estimate, the conditions and, where applicable, the duration of the extension of the execution period.
- 11) **PAYMENT TERMS.** A deposit of 40% of all the work will be requested when ordering/signing the estimate. An invoice for a second deposit of 40% will be sent at the start of implementation on the construction site. The company grants itself the right to establish situation invoices according to the progress of the work and amendments to the estimate. The company also reserves the right not to start work until payment of the installments. The Buyer can never, under the pretext of a complaint made by him against SARL AW, retain any right not to start the work until the payment of the deposit. The Buyer may never, under the pretext of a complaint made by him against SARL AW, withhold all or part of the sums due by him or demand compensation.
- 12) **LATE PAYMENT.** In the event of late payment and payment of sums owed by the Buyer beyond the fixed deadline, and after the date of payment appearing on the invoice sent to the latter, a late payment penalty calculated at the interest rate applied by the ECB to its most recent refinancing operation increased by 10 points of the amount including tax of the acquisition price appearing on the invoice will be automatically and automatically acquired by SARL AW without any formality or prior formal notice, without prejudice to any other action that the company would be entitled to bring, in this respect, against the Buyer. Furthermore, in accordance with articles 441-6c. com. and D. 441-5 c. com, a lump sum compensation for recovery costs, in the amount of FORTY (40) Euros will be due, automatically and without prior notification, in the event of late payment. SARL AW reserves the right to ask the Buyer for additional compensation if the recovery costs actually incurred exceed this amount, upon presentation of supporting documents.
- 13) **RETENTION OF OWNERSHIP.** Reserve clause: In accordance with the law of May 12, 1980, the goods delivered and the work carried out remain our property until full payment, both of the goods and of the labour. In the event of non-payment, and after formal notice, we reserve the right to recover the goods with dismantling costs and losses borne by the client.
- 14) **TECHNICAL REQUIREMENTS.** The work will be carried out in accordance with the rules of the art in force on the date of signature of the estimate; otherwise, a reciprocal agreement will be necessary. The company will refuse any execution of work that does not comply with the rules of the art and may possibly refuse to use materials or products supplied by the customer. The conditions for the supply of materials by the client (or his representative) are provided for in the special conditions.
- 15) **AGREEMENT OF THE PARTIES.** The signature by the customer and the company of the estimate implies their total agreement on the nature, the circumstance and the price of the work as well as their condition of payment and execution listed above.
- 16) **JURISDICTION.** Any dispute relating to the interpretation and execution of these general conditions of sale is subject to French law. In the absence of an amicable resolution, the dispute will be brought before the Court depending geographically on the company, i.e. the Court of Albertville.